

PARTY STICK™

Quick Reference

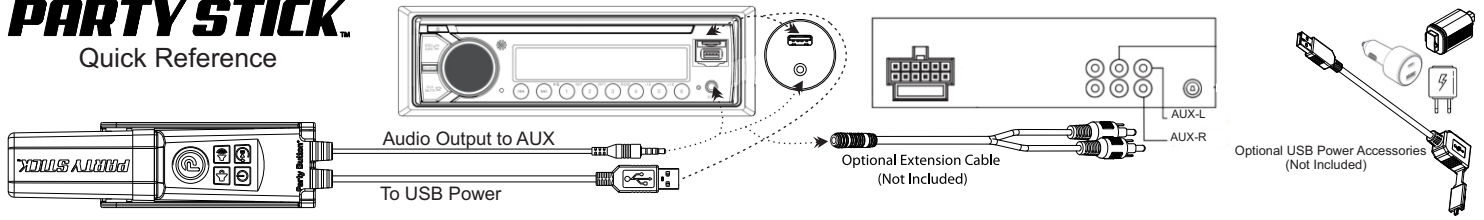

Mobile Device Pairing Instructions

Pair to **PartyButton** in your mobile device settings. The Party Stick must be in Single Listener or DJ Broadcast modes to pair to a mobile device. The Power button will blink when a mobile device is not paired and will be solid after successfully pairing.

Caution:

Not for use while in motion. All vehicles should be stopped and parked when sharing music using the Party Sticks.

SETTING UP A PARTY:

- 1 Decide who will DJ the Party and who will listen.
- 2 DJ: Click the Party Button on your Party Stick until  Party Button turns purple "DJ Broadcast Mode". Press and hold Party Button to enter "Broadcast Pairing". The Party Button will blink while in Broadcast Pairing mode. Multiple listeners can join simultaneously during this time. Broadcast Pairing mode will timeout after 5 minutes or you can press and hold the Party Button to end Broadcast Pairing mode.
- 3 Listeners: Click the Party Button on your Party Stick until  Party Button turns red "DJ Listening Mode". Press and hold Party Button to enter "Broadcast Pairing". Listeners will get an audible confirmation when pairing completes. Listeners may leave the Party by using the Party Button to switch to Single Listener Mode and rejoin at any time by simply entering DJ Listening Mode again.

Volume controls while in DJ Listener Mode:

Listeners can control the local volume on their system by using the volume decrease/increase buttons. However, anytime the DJ adjusts the DJ "master volume" it will reset all listeners to the new DJ volume level. The mute/reset button will mute music when in DJ Listening mode and reset your volume to the last local volume setting when unmuted.



Party Button: Click-Press cycles through the modes listed below..

 Blue: Single Listener Mode (Standalone)

 Purple: DJ Broadcast Mode

 Red: DJ Listening Mode (rejoins previous "Party" if available).



Volume Decrease



Volume Increase



Power On/Off (Quick press and release. The Party Stick has a delayed On/Off)



Pause/Play/Mute/Reset:

Pause/Play music when in Single Listener or DJ Broadcast modes.

Mute music when in DJ Listening mode and reset to the last local volume setting when unmuted.

Party Stick Quick Reference 2024/01/03

FCC Warning Statement

Changes or modifications not expressly approved by the party responsible for compliance could void the user's authority to operate the equipment. This equipment has been tested and found to comply with the limits for a Class B digital device, pursuant to Part 15 of the FCC Rules. These limits are designed to provide reasonable protection against harmful interference in a residential installation. This equipment generates uses and can radiate radio frequency energy and, if not installed and used in accordance with the instructions, may cause harmful interference to radio communications. However, there is no guarantee that interference will not occur in a particular installation. If this equipment does cause harmful interference to radio or television reception, which can be determined by turning the equipment off and on, the user is encouraged to try to correct the interference by one or more of the following measures:

- Reorient or relocate the receiving antenna.
- Increase the separation between the equipment and receiver.
- Connect the equipment into an outlet on a circuit different from that to which the receiver is connected.
- Consult the dealer or an experienced radio/TV technician for help.

This device complies with part 15 of the FCC Rules. Operation is subject to the following two conditions: (1) This device may not cause harmful interference and (2) this device must accept any interference received, including interference that may cause undesired operation. The device has been evaluated to meet general RF exposure requirement."

Applies to, but not limited to, the following:

FCC ID: 2A4ZE-INV-USB